

LANGDON

272074 272070

270252

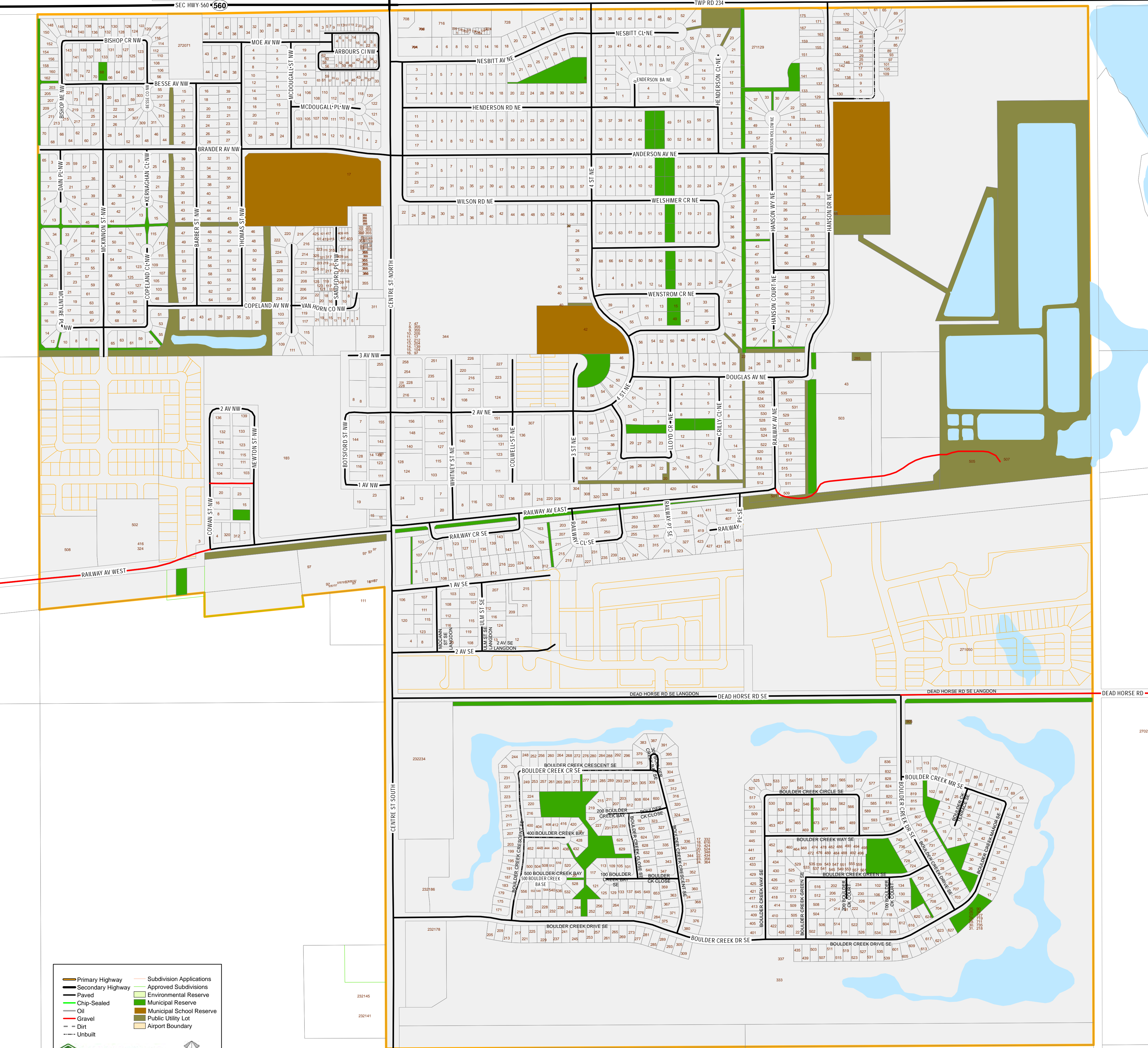

Legend

- Primary Highway
- Secondary Highway
- Paved
- Chip-Sealed
- Oil
- Gravel
- Dirt
- Unbuilt
- Subdivision Applications
- Approved Subdivisions
- Environmental Reserve
- Municipal Reserve
- Municipal School Reserve
- Public Utility Lot
- Airport Boundary

ROCKY VIEW COUNTY
Cultivating Communities

REV. Oct, 2016